



DOUBLE Y-FIT W/TOGGLE ENDS AND GRIPPLE ASSEMBLY

FLUORESCENT LIGHTING FIXTURES



Double leg Y-FIT



Toggle End



Double Leg Y-Fit

Each Hanger comprises a length of steel wire rope with 2 hanging points at one end to form a Y configuration. The double end is fitted with a GripPle and Toggle end fixings.

Toggle End

A restraining toggle plate and end stop fitted at one end of the wire rope allows the Hanger to be easily fitted into pre-punched sheet metal housing.

General Guidelines:

1. Draw the toggle plate back from the end stop and align down the length of the wire rope.
2. Push the end stop and plate through hole.
3. When the toggle plate has cleared the hole, pull back on the cable, or simply let the weight of the fixture settle onto the toggle.

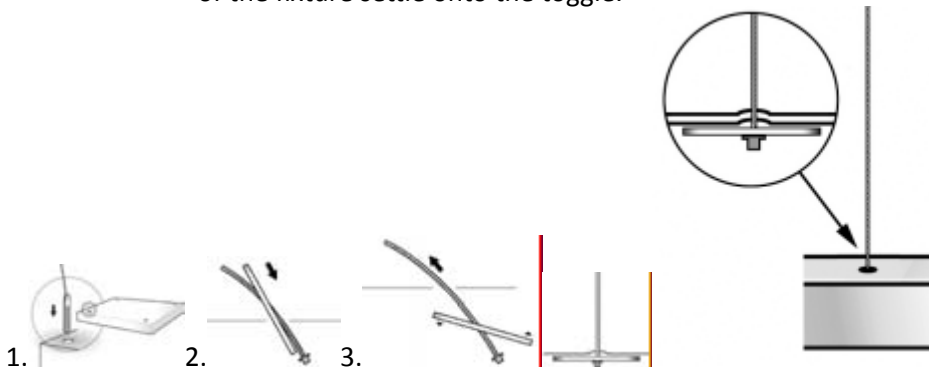

GRIPPLE ASSEMBLY

Gripple assembly:

1. Push the rope tail end through one channel of the Gripple.
2. Pass the rope through the fixing point off of the ceiling.
3. Return the rope to the Gripple and push through the second channel. Pull the required length of the rope through to raise the fixture to the desired height.

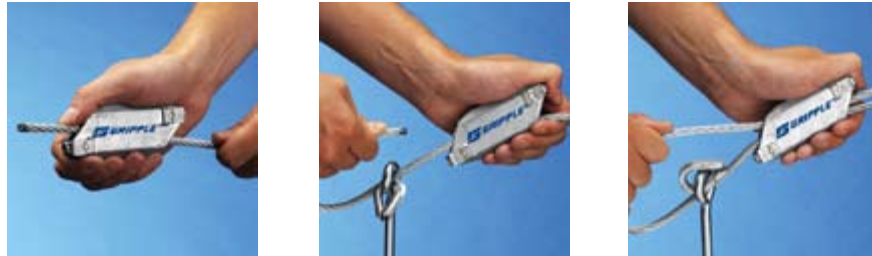

To shorten the assembly:

1. Pull more rope through the Gripple by pulling on the free tail end. This will reduce the size of the loop contained by the Gripple; or
2. Take the Gripple up the active line that connects the object to the overhead anchoring point. This has the effect of increasing the size of the loop contained by the Gripple.

To lengthen the assembly:

1. Before an assembly can be lengthened, first check that there is sufficient free tail outside the Gripple, or free rope inside the Gripple, to provide the desired increase in length.
2. Before starting any adjustment, ensure that the load on the assembly is removed.
3. Use the setting key to disengage the wedge inside the Gripple and pull the required length of rope through. Remove the setting key so that the wedge is securely backed in contact with the rope.

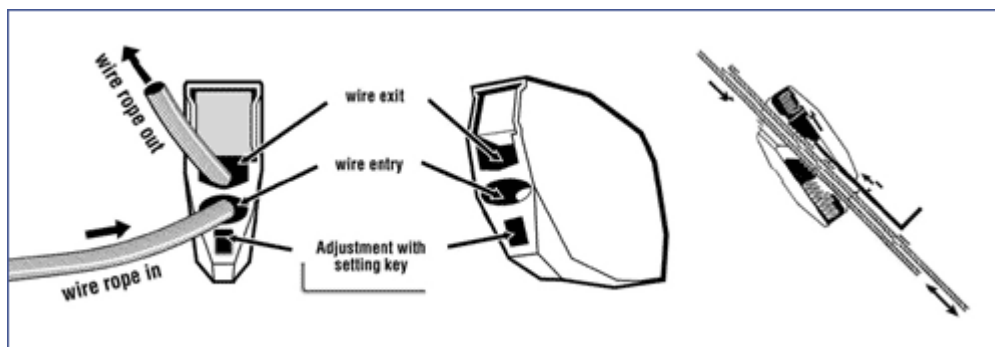

Helpful Hint - Always try to set the object to be installed low and adjust upwards to the required height.

INSTALLATION GUIDELINES

- Do not exceed the Safe Working Load (SWL) of the product
- Always load the product within its working load range
- Check that the Gripple mechanism is fully engaged
- Ensure that loads are carried evenly across all Hangers
- No in-line joins
- Do not use on coated wire
- Do not apply paint or other coatings
- Do not apply lubricants
- Do not use for lifting
- Inspect periodically
- Remove damaged wire ends before inserting into the Gripple
- Do not use in chlorinated atmospheres (see Stainless Steel Gripple Hangers)

Safe Working Loads

| Size | Weight Range | SWL (safe working load) |
|------|--------------|----------------------------|
| No.2 | 22-100 lbs | 100 lbs |

Component Parts

Self Locking Gripple Component Parts

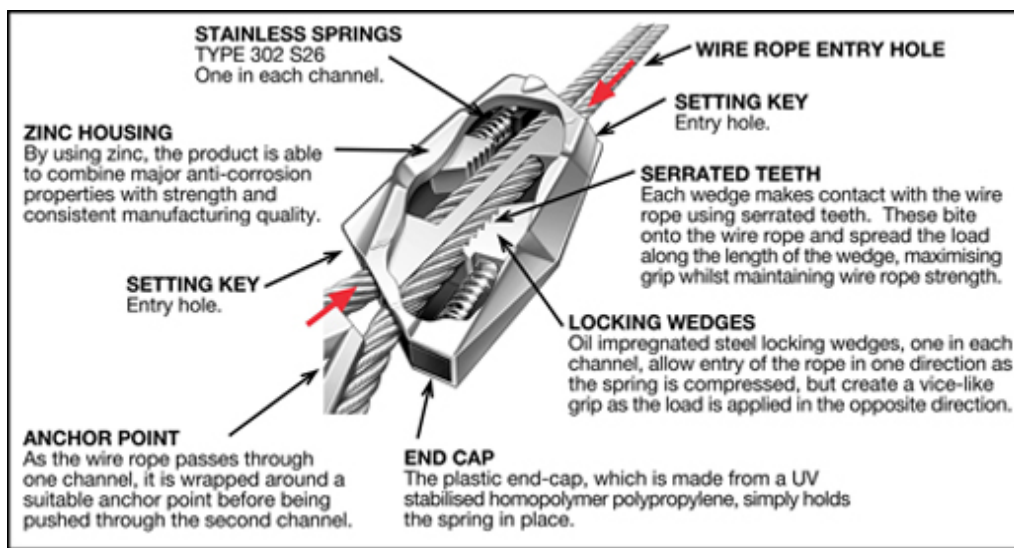



LDPI, Inc.
Eau Claire, WI 54703
TOLL FREE
1-800-854-0021
Web: www.ldpi-inc.com
E-mail: sales@ldpi-inc.com