

The LEHB1 Series LED Luminaire combines optical performance, energy efficiency, and outstanding versatility to meet the demand of industrial environments with high ambient temperatures and wet applications in heavy industrial plants, foundries, steel Mills, pulp and paper mills as well as aircraft hangars and shipyards also delivers a wide range of light outputs from 30,000 up to 100,000 lumens that replace 400W-2,000W HID / HPS / metal halide fixtures. The LEHB1 Series offers higher efficacy for increased energy savings, lower maintenance costs and shorter paybacks.

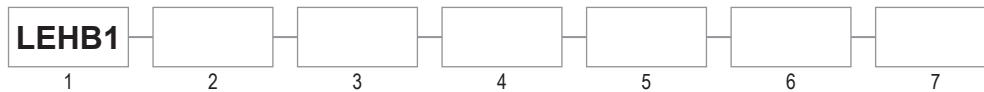

1 SERIES	2 SOURCE	3 VOLTAGE	4 AMBIENT TEMPERATURE	5 CCT	6 OPTICS	7 LENS
LEHB1	L1: 200W L2: 400W L3: 600W L4: 800W	V1: 120-277VAC (50/60Hz) V2: 347-480VAC (50/60Hz)	65: 65°C (Poly lens max Ta.) 70: 70°C (Glass lens max Ta.)	3: 3,000K 4: 4,000K 5: 5,000K 57: 5,700K	15: 15** T3: Type III* 30: 30** T5: 120† 60: 60** 3012: 30x120** 90: 90**	C: Clear Glass D: Frosted Glass P: Polycarbonate

\* Polycarbonate lens only  
† Clear glass lens only

### CERTIFICATIONS

UL1598 / CSA-C22.2 No.250 (Wet/Damp)  
Lumen Maintenance (L70) > 110,000 hrs. (reported)  
-40°C to 65°C Ambient (w/ poly lens)  
-40°C to 70°C Ambient (w/ glass lens) **Driver: 24/7 operation:**  
CRI >70 20,000 hrs. @ 70°C  
IP66 / IP67 30,000 hrs. @ 65°C  
IK08 (Glass) / IK10 (Polycarbonate) 43,800 hrs. @ 60°C  
ASTM B117-11 (1,000 hrs. salt spray tested)  
FCC / CE / RoHS

### CONSTRUCTION

Corrosion resistant aluminum alloy  
High temp silicone gaskets  
Thermal shock and impact resistant tempered glass or polycarbonate lens  
All exposed fasteners stainless steel  
Standard Black durable coated finish  
Weights: See dimensions drawing

### ELECTRICAL

120-277VAC or 347-480VAC  
Built in 6kv surge protection  
Dimming 0-10V, 5ft. blunt end cord, capped at end

### FEATURES

High luminous efficacy - Up to 150 Lm/W  
Instant illumination and restrike. No warm-up time required  
5 year warranty

### PERFORMANCE

Source	Voltage (VAC) 50/60Hz	Input Current (A)	Wattage (W)	CCT	Lumen Output* (Lm)
L1	120-277	1.67-0.81	200W	3,000K	30,000
				4,000K	
	347-480	0.58-0.42		5,000K	
				5,700K	
L2	120-277	3.34-1.62	400W	3,000K	60,000
				4,000K	
	347-480	1.16-0.84		5,000K	
				5,700K	
L3	120-277	5.01-2.43	600W	3,000K	90,000
				4,000K	
	347-480	1.74-1.26		5,000K	
				5,700K	
L4	120-277	6.68-3.24	800W	3,000K	100,000
				4,000K	
	347-480	2.32-1.68		5,000K	
				5,700K	

\*Nominal values

### ACCESSORIES (Ordered Separately, Factory Installed)

SP01: 10KV Surge Protector for 120-277V (Junction Box)  
SP02: 10KV Surge Protector for 347-480V (Junction Box)  
WG06: Wire Guard\*  
SC05: 3ft. Safety Cable Kit\*

\*Can be field installed

Product comes standard with:

Junction Box (Factory Installed)  
Dimming (0-10V, 5ft. Blunt-End Cable)  
10ft. Blunt-End Power Cord

# LEHB1

## HIGH TEMP. LED HIGH BAY

Foundries • Steel Mills • Pulp/Paper Mills • Shipyards • Aircraft hangars • Heavy Industrial



Dimming Wires  
5ft. cord w/ blunt end  
(standard)

M12

Power Cord  
10ft. cord w/ blunt end  
(standard)

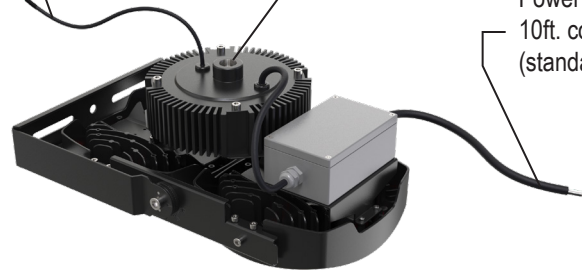

### DIMENSIONS / WEIGHTS

200W Fixture Shown with U-Bracket

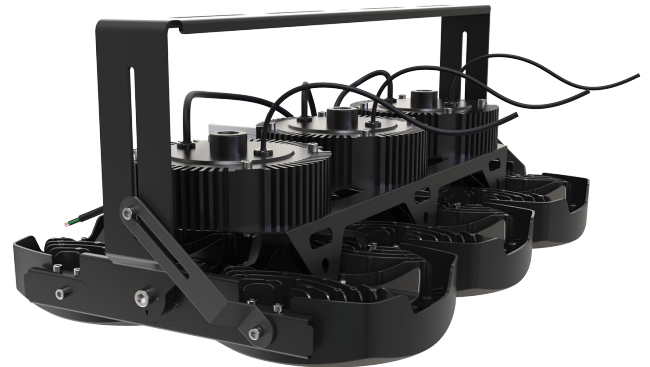
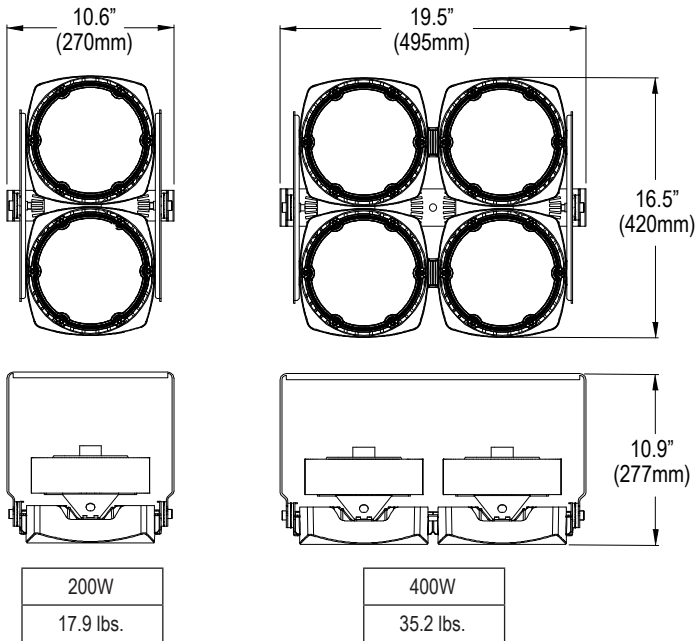

600W shown with U-Bracket & vibration reinforcement  
(Vibration reinforcement brackets included on 600W & 800W models)  
(Must be field installed)

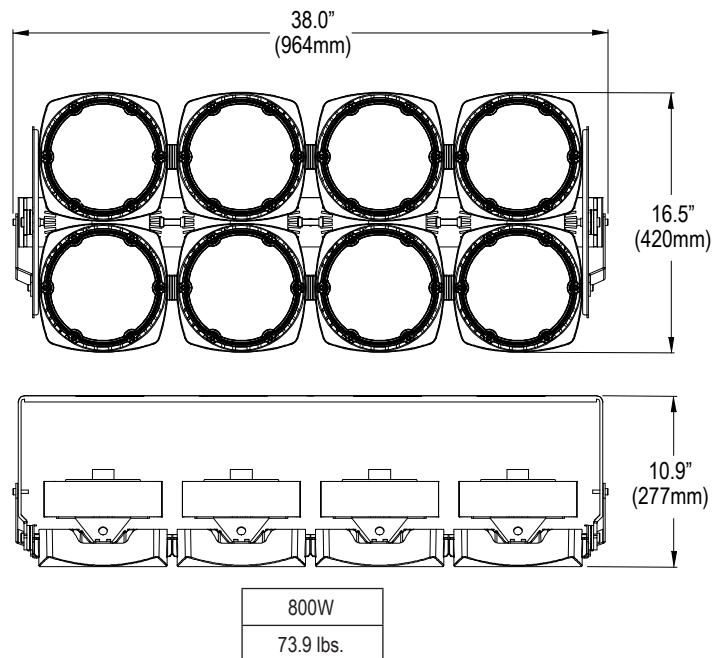
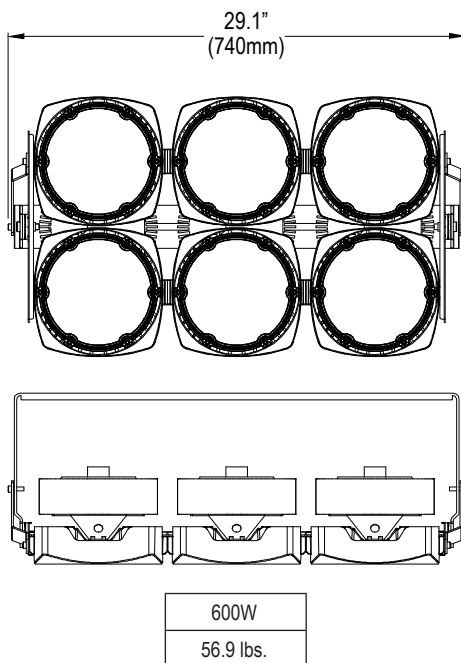

1-800-854-0021 www.ldpi-inc.com  
LDPI® is a registered trademark of LDPI, Inc. © LDPI, Inc.

Product design and specifications subject to change without notice.  
Visit www.ldpi-inc.com for the most current version and photometric data. v.10.26.22



# LEHB1

## HIGH TEMP. LED HIGH BAY

Foundries • Steel Mills • Pulp/Paper Mills • Shipyards • Aircraft hangars • Heavy Industrial

### U-BRACKET MOUNTING - FIELD INSTALLED

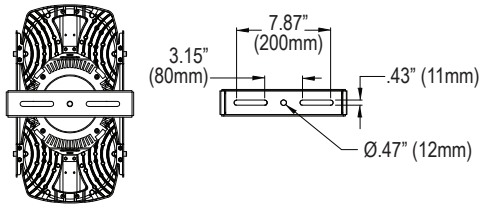

**200W U-Bracket | Ordering Code: UB-FLH-200**

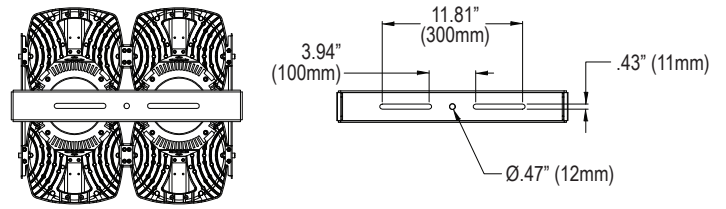

**400W U-Bracket | Ordering Code: UB-FLH-400**

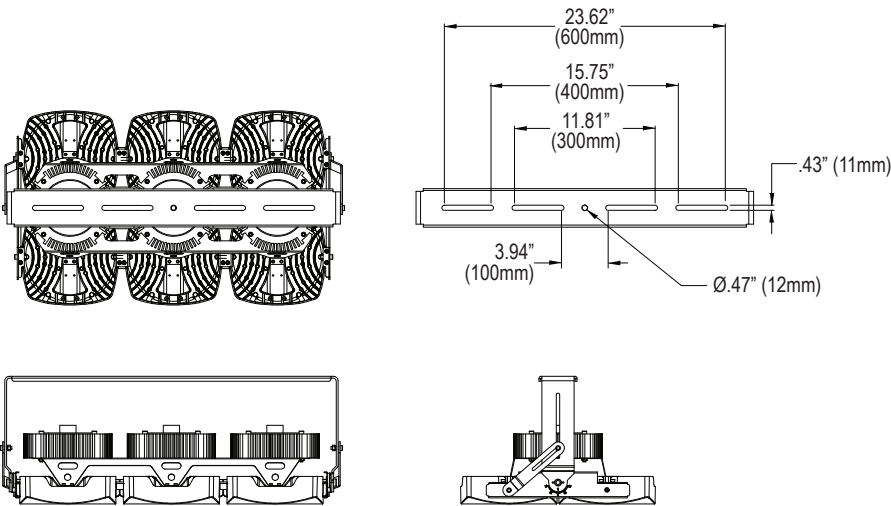

**600W U-Bracket | Ordering Code: UB-FLH-600**

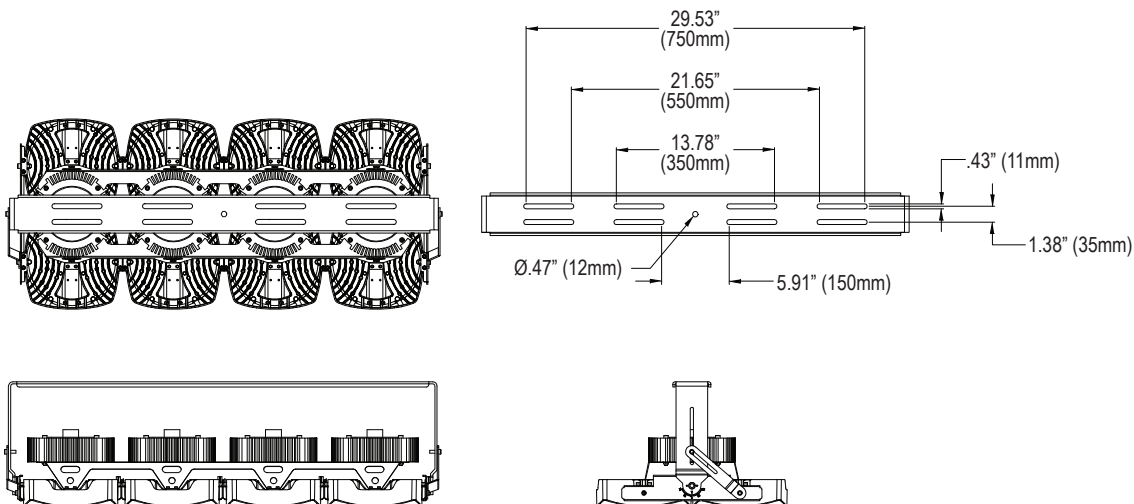
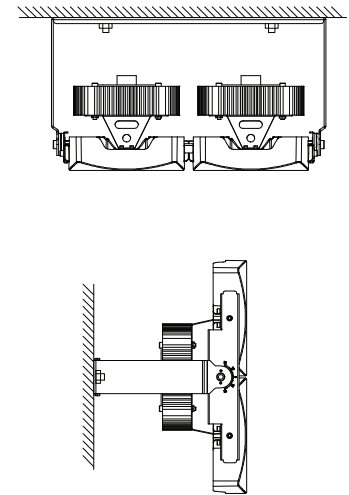

**800W U-Bracket | Ordering Code: UB-FLH-800**



# LEHB1

## HIGH TEMP. LED HIGH BAY

Foundries • Steel Mills • Pulp/Paper Mills • Shipyards • Aircraft hangars • Heavy Industrial



### HOOK / EYEBOLT MOUNTING / SUPPORT BAR - FIELD INSTALLED

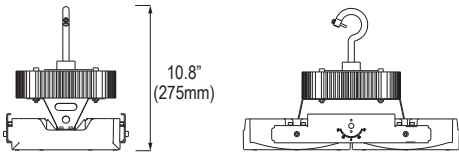
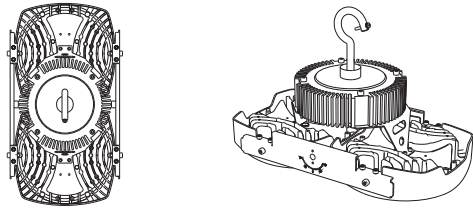

200W (Hook/Eyebolt)

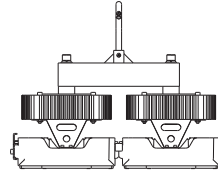
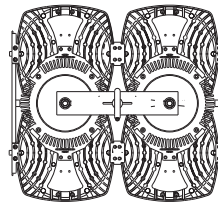

400W Support Bar | Ordering Code: SB40

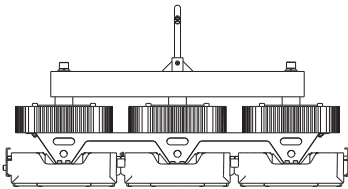
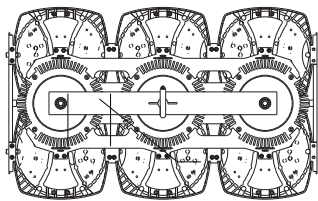
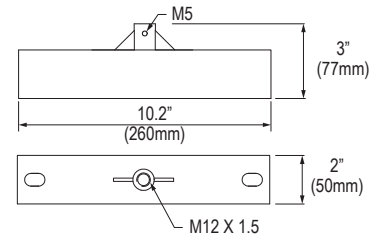

600W Support Bar | Ordering Code: SB60

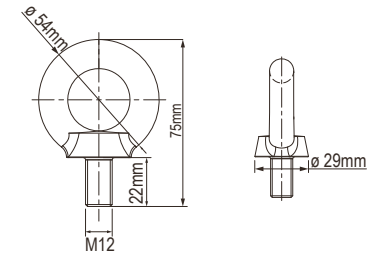
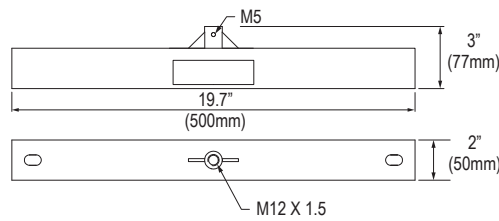

Eyebolt | Ordering Code: HK01

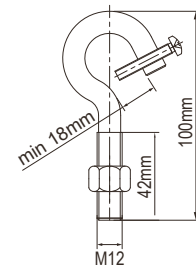

Malleable Hook | Ordering Code: HK02

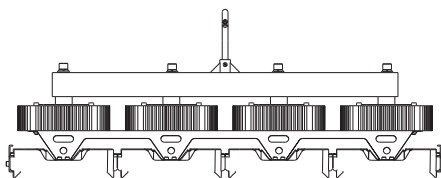
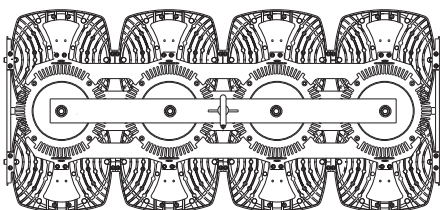

800W Support Bar | Ordering Code: SB80

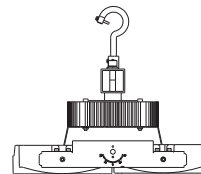
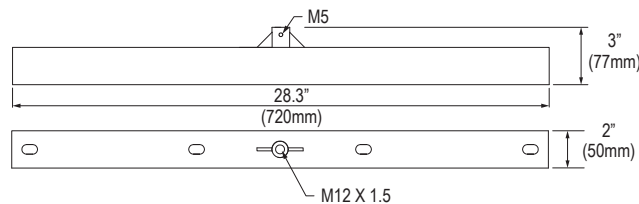

1-800-854-0021 www.ldpi-inc.com  
LDPI® is a registered trademark of LDPI, Inc. © LDPI, Inc.

Product design and specifications subject to change without notice.  
Visit [www.ldpi-inc.com](http://www.ldpi-inc.com) for the most current version and photometric data. v.10.26.22

# LEHB1

## HIGH TEMP. LED HIGH BAY

Foundries • Steel Mills • Pulp/Paper Mills • Shipyards • Aircraft hangars • Heavy Industrial



### PENDANT MOUNTING / FLANGE - FIELD INSTALLED

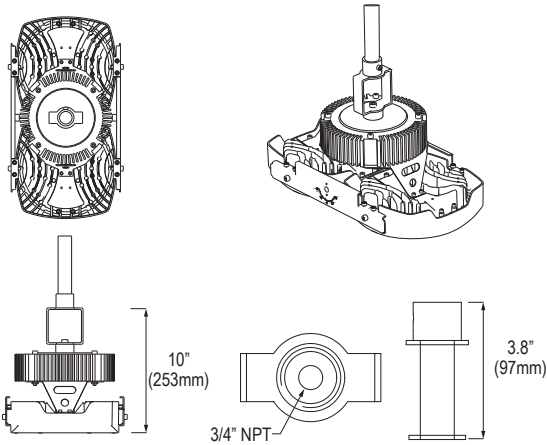

**200W Flange | Ordering Code: FL20**

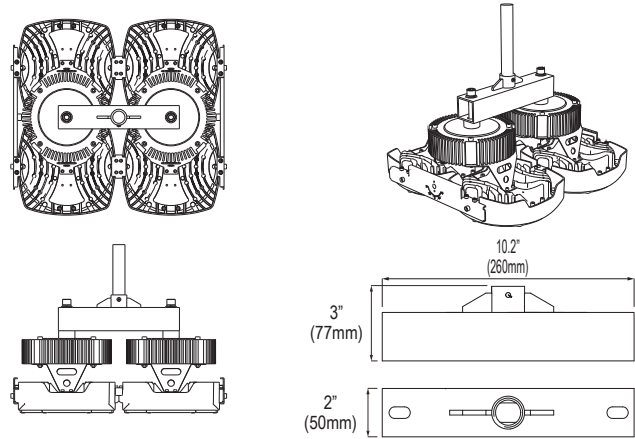

**400W Flange | Ordering Code: FL40**

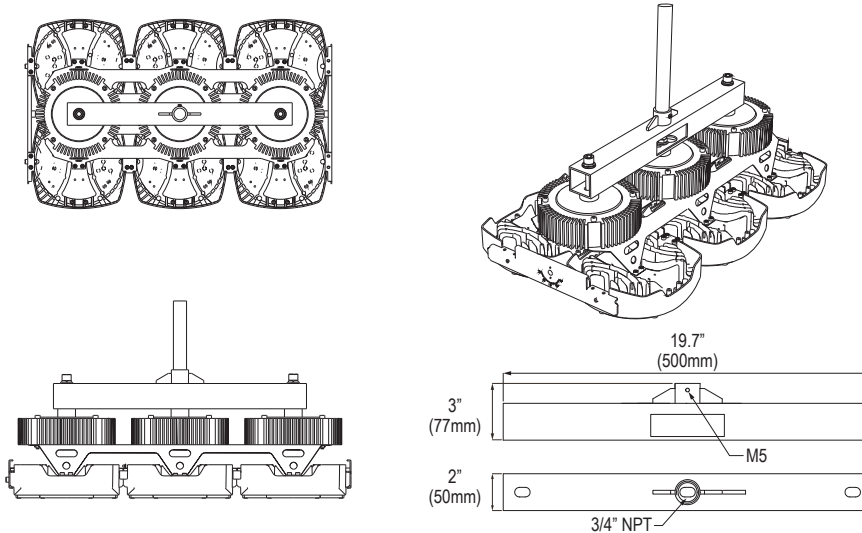

**600W Flange | Ordering Code: FL60**

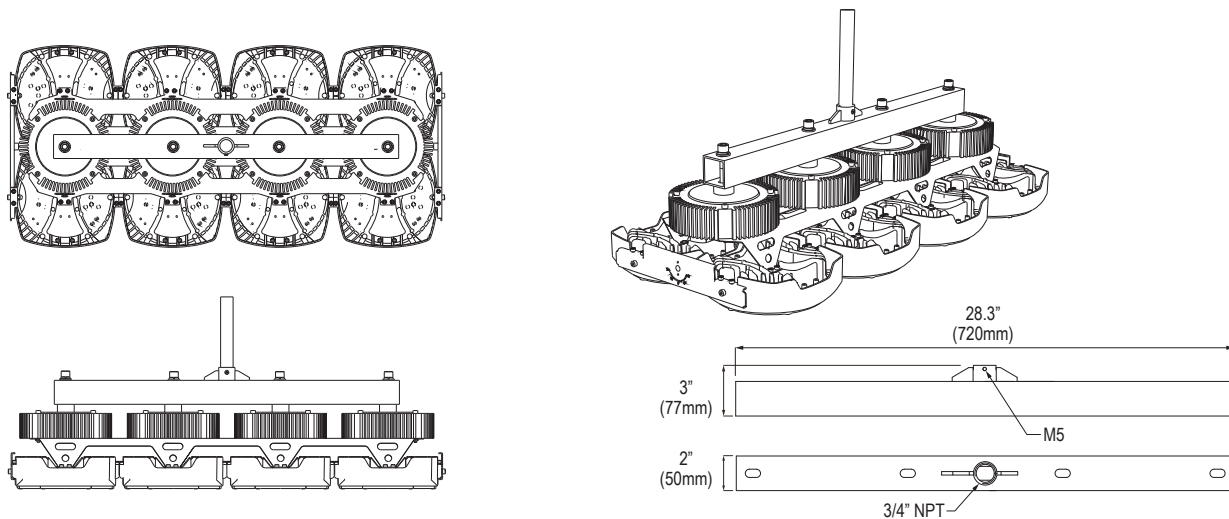
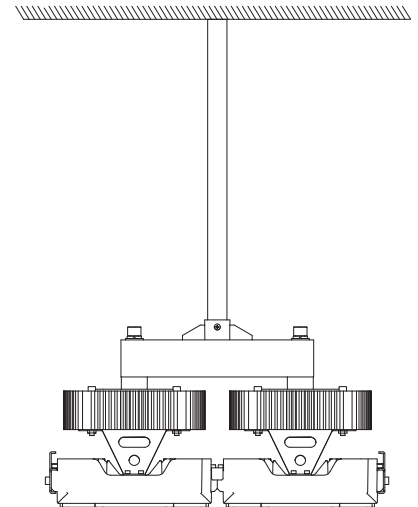

**800W Flange | Ordering Code: FL80**



1-800-854-0021 www.ldpi-inc.com  
LDPI® is a registered trademark of LDPI, Inc. © LDPI, Inc.

Product design and specifications subject to change without notice.  
Visit [www.ldpi-inc.com](http://www.ldpi-inc.com) for the most current version and photometric data. v.10.26.22