

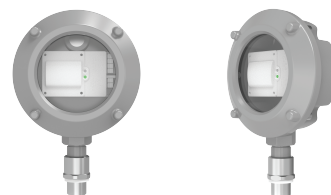

Specifications:



Model NO.	LCX-OCC-D2	LCX = Series, OCC = Sensor Type, D2 = Rating (CID2)
Input	DC Input Voltage	N/A
	Rated Voltage	AC120-277V, 50/60Hz
	No-load Power	N/A
	Stand-by Power	≤ 1W
	Surge Test	L - N: 1kV
Output	Working Mode	ON/OFF, 1-10V dimming
	Type of Load	Resistive or capacitive
	Load Capacity	120V/4.5A; 277V/2A
	Max.Power	550W
	Max. Surge Capacity	30A (50% Ipeak, Twidth =500uS, @230Vac full load, cold start); 60A (50% Ipeak, Twidth =200uS, @200Vac, full load, cold start)
Dim Interface	1-10V Dimming	20mA Max., Passive 1-10V ports
	High Low Voltage Control	N/A
	PWM Control	N/A
Sensor Parameters	Operating Frequency	5.8 GHz ±75 MHz, ISM band
	Transmitting Power	0.5mW Max.
	Hold Time	5s/30s/1min/3min/20min/30min 5s/30s/1min/3min/5min/10min/20min/30min (set by remote control)
	Stand-by Period	0s/5s/5min/10min/30min/1h/+∞ 0s/10s/1min/3min/5min/10min/30min/+∞ (set by remote control)
	Detection Area	10 %/75%/50%/10% 10 %/75%/50%/25% (set by remote control)
	Daylight Sensor	5Lux/15Lux/30Lux/50Lux/100Lux/150Lux/Disable (ambient light diffuse state) 5lux/15lux/30lux/50lux/10 lux/150lux/Disable (set by remote control)
	Detecting Radius	2-3m @mounting height of 10m
	Mounting Height	12m Max.
	Detection Angle	150°
Operating Environment	Ambient Temperature	- 25°C to +60°C
	Storage	- 40°C to +80°C/Humidity: 10%-95% (non-condensing)
Others	Input/Output Terminal	Press-type terminal block; Wire diameter: 0.75-1.5mm ²
	Material	Housing: Aluminum
	High Low Voltage Control	N/A
	IP Rating	IP66
	Protection Class	Class I, Division 2, Groups A, B, C, D
	Lifetime	50,000 hours

Note: 1. "N/A" means not available.

2. The detection area is related to the speed and volume of the moving object. This data was obtained from testing personnel with a height of 165cm and a movement speed of 0.5m/s.

LCX-OCC-D2

CID2 OCCUPANCY SENSOR

Default Settings:

Detection Area	100%
Hold Time	5s
Stand-by Period	0s
Stand-by DIM LEVEL	10%
Daylight Sensor	Disable
Mode	On

Functions:

1. ON/OFF Function (Stand-by period set as "0s")

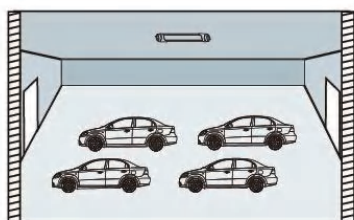

- ① With sufficient ambient light, the light will not be switched on even if motion is detected.

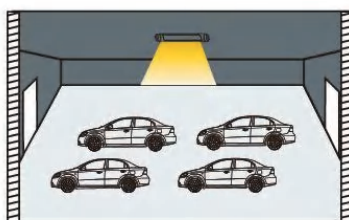

- ② With insufficient ambient light, the sensor switches on the light automatically when motion is detected.



- ③ After elapse of hold time, the sensor switches off the light if no motion is detected.

2. Two-step Dimming Function (Stand-by period set as "+∞")

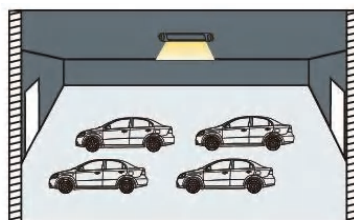

- ① If there is no motion detected, the light will be remained at a low light level all the time.

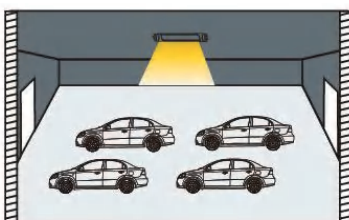

- ② When motion is detected, the sensor will switch on the light to 100% brightness.



- ③ After elapse of hold time, the sensor dims the light at a low light level if no motion is detected.

3. Three-step Dimming Function (Stand-by period set as "5S/5min/10min/30min/1h")

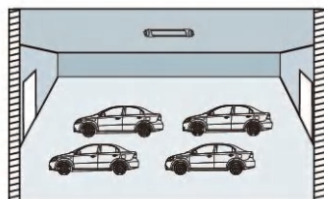

- ① With sufficient ambient light, the light will not be switched on even if motion is detected.

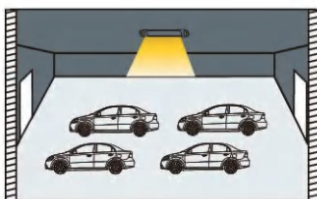

- ② With insufficient ambient light, the sensor switches on the light automatically when motion is detected.

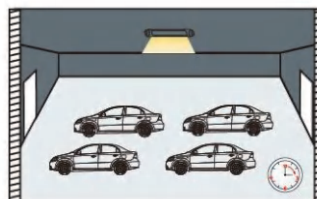

- ③ After elapse of hold time, the sensor dims the light at a set low light level if no new motion is detected.

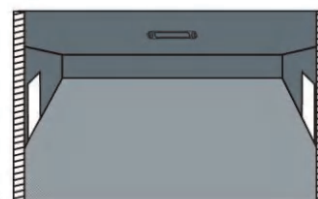

- ④ After elapse of stand-by period, the sensor switches off the light if no motion is detected in the detection area.

LCX-OCC-D2

CID2 OCCUPANCY SENSOR

Dimensions: mm/inch

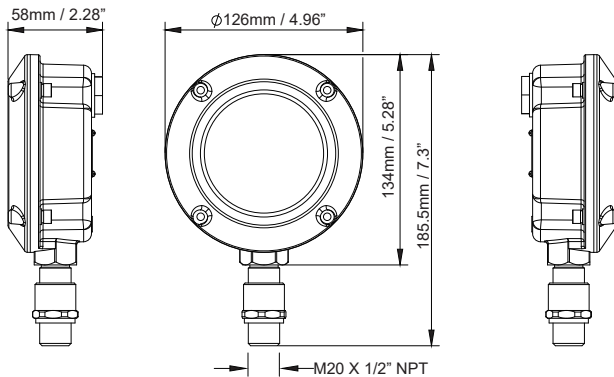

Product comes standard with:

- (2) Extenders
- (1) 1/2" NPT to 3/4" NPT Adapter
- (1) Remote

Radiation Pattern

(1) Ceiling Mounting

Ceiling mounted height: 10m

Sensitivity: 100%

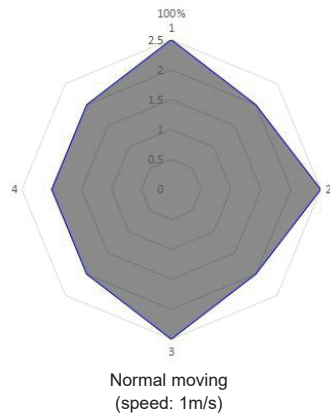

Normal moving
(speed: 1m/s)

(2) Wall Mounting

Horizon mounted height: 2m

Sensitivity: 100%/75%/50%/25%

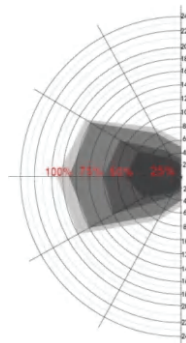

Normal moving
(speed: 1m/s)

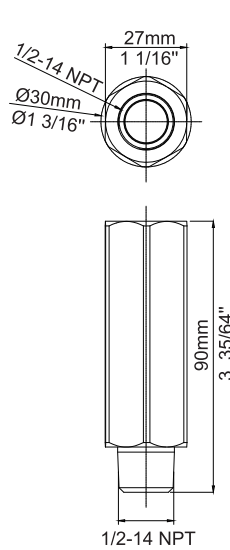

Extender: 1/2" NPT / 1/2" NPT

Material: SUS304

Weight: 0.277kg

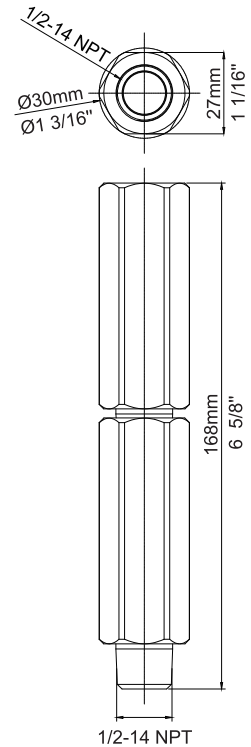

Extender: 1/2" NPT / 1/2" NPT

Material: SUS304

Weight: 0.554kg

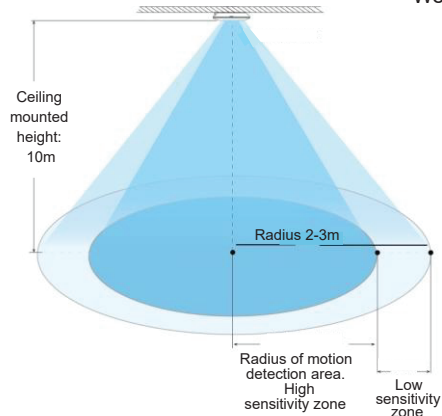

LCX-OCC-D2

CID2 OCCUPANCY SENSOR

Remote Control (Included)

*Warning: Remote control equipment should be used in unclassified, ordinary locations and it is strictly prohibited to use in hazardous (classified) locations.

Remote Control Setting	Button	Remarks																				
	ON/OFF	Press the "ON/OFF" button, the light goes to constant on/o mode, sensor is disabled. Press "Reset" "Auto mode" button to quit from this mode and the sensor starts to work.																				
	Reset	Press "Reset" button, all parameters are same as setting of DIP switch or factory settings.																				
	Sensor motion	Press "Sensor motion" button, the light quits from the constant on/o mode, and the sensor starts to work (the latest setting stays in validity).																				
	DIM Test	Press "DIM Test" button, the 1-10V dimming works to test whether the 1-10Vdc dimming ports are connected properly. After 2s, it returns to the latest setting automatically.																				
	Override DH	Long press 3s, Daylight priority mode will be switched to daylight threshold mode, lux value will go back to previous one.																				
	DIM+	Short press "DIM+/DIM-" button to set the output lumen level, each press will adjust 2% light level.																				
	DIM-																					
	DH Mode	Long press 3s, sensor will be switched to daylight priority mode; if preset daylight value is Disable, pressing DH Mode can not start daylight priority mode.																				
	Q1 Q2 Q3	<table border="1"> <thead> <tr> <th>Scene Options</th> <th>Detection Area</th> <th>Hold Time</th> <th>Stand-by Period</th> <th>Stand-by dim level</th> </tr> </thead> <tbody> <tr> <td>QS1</td> <td>100%</td> <td>5min</td> <td>10min</td> <td>10%</td> </tr> <tr> <td>QS2</td> <td>100%</td> <td>10min</td> <td>30min</td> <td>10%</td> </tr> <tr> <td>QS3</td> <td>100%</td> <td>20min</td> <td>30min</td> <td>10%</td> </tr> </tbody> </table>	Scene Options	Detection Area	Hold Time	Stand-by Period	Stand-by dim level	QS1	100%	5min	10min	10%	QS2	100%	10min	30min	10%	QS3	100%	20min	30min	10%
Scene Options	Detection Area	Hold Time	Stand-by Period	Stand-by dim level																		
QS1	100%	5min	10min	10%																		
QS2	100%	10min	30min	10%																		
QS3	100%	20min	30min	10%																		
	TEST 2S	Note: Detection area/Hold time/Stand-by period /Stand-by dim level/Daylight sensor can be adjusted by pressing the corresponding button. The latest setting will stay valid. Press the "TEST 2S" button to enter the test mode any time. At the mode, the sensor parameters as follow: Detection Area is 100%, Hold Time is 5s, Stand-by Dim Level is 10%, Stand-by Period is 0s, daylight sensor disable. This function only for testing. Quit the mode by pressing "RESET" or any other function buttons.																				
	HS	Press "HS" button to set the detection area as high sensitive.																				
	LS	Press "LS" button to set the detection area as low sensitive.																				
	Daylight Sensor	Set up daylight threshold: 5Lux/15Lux/30Lux/50Lux/100Lux/150Lux/Disable																				
	Stand-by period	Set up stand-by time: 0S/10S/1min/3min/5min/10min/30min/+∞																				
	Hold time	Set up hold time: 5S/30S/1min/3min/5min/10min/20min/30min																				
	Stand-by dim level	Set up stand-by dim level: 10%/20%/30%/50%																				
	Detection Area	Set up detection area: 25%/50%/75%/100%																				
	Remote Distance	Toggle button to set the remote distance of remote control and sensor																				